

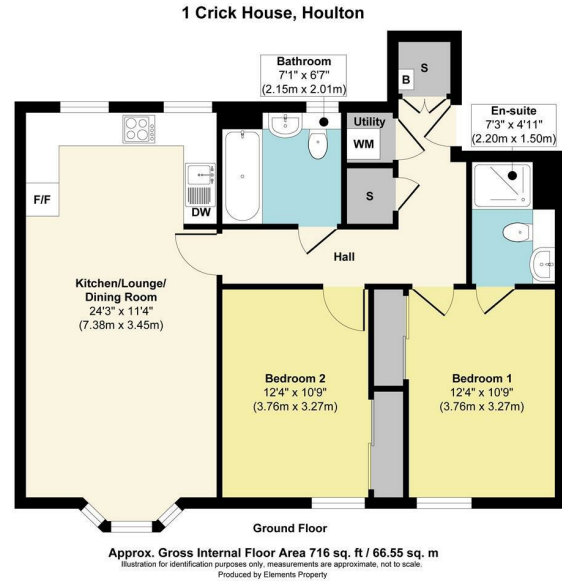

**2 Bed Apartment
located in Houlton**



**1 Crick House Station
Avenue
Houlton
Rugby
CV23 1DA**



Asking Price £200,000

CONTACT

Office 1H
Valiant Office Suites
Lumonics House
Valley Drive, Rugby
Warwickshire
CV21 1TQ

EMAIL

sales@acdc.agency

TELEPHONE

0333 335 5445

<http://www.acdcsalesandlettings.co.uk>

SUMMARY

ACDC Sales & Lettings welcome to the market this modern ground floor apartment located on Station Avenue in the charming area of Houlton, Rugby. Built in 2020, this nearly new property offers a fresh and contemporary living experience, perfect for those seeking comfort and convenience.

