

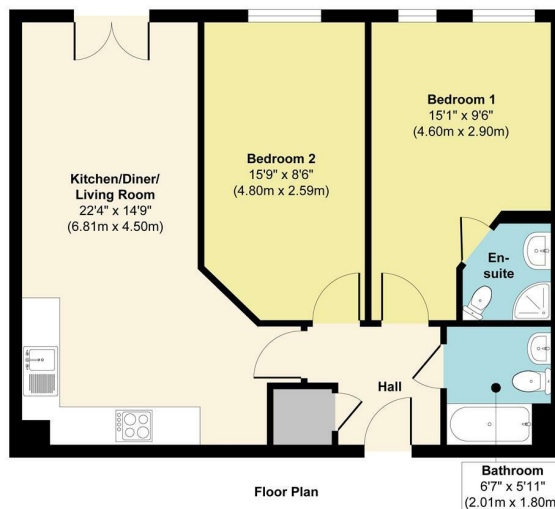

2 Bed Apartment
located in



**Apartment 10, Gilbert
House 2 Elmira Way
Salford
M5 3DE**



Approx. Gross Internal Floor Area 631 sq. ft / 58.62 sq. m
Illustration for identification purposes only, measurements are approximate, not to scale.
Produced by Elements Property

Asking Price £180,000

CONTACT

Office 1H
Valiant Office Suites
Lumonics House
Valley Drive, Rugby
Warwickshire
CV21 1TQ

EMAIL

sales@acdc.agency

TELEPHONE

0333 335 5445

<http://www.acdcsalesandlettings.co.uk>

SUMMARY

ACDC Sales & Lettings are delighted to bring to market this fantastic opportunity to purchase this two bedroom apartment in the desirable area of Salford, situated next to Central Bay. The property benefits from close proximity restaurants, bars, Vue cinema and only 10 minutes from Manchester City Centre. Additional benefits feature off-road parking, great views and is being sold with NO ONWARD CHAIN!

Media City

